

Exploded view

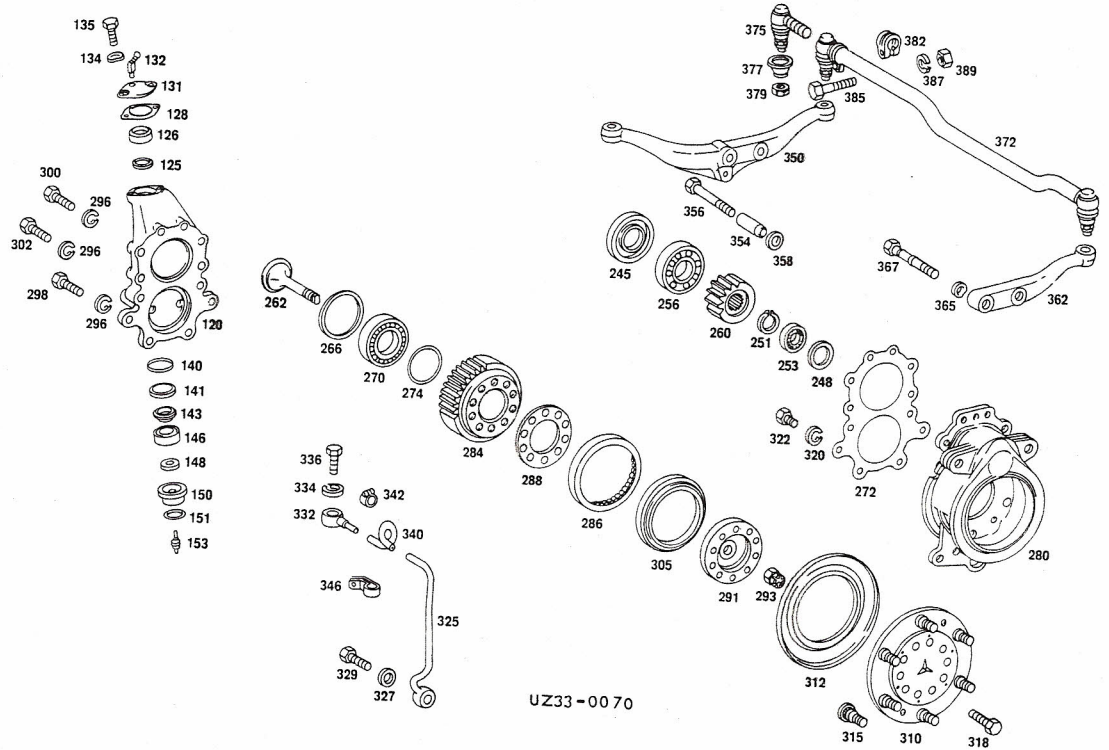

Steering knuckle and wheel hub drive

- |                                |                                |                          |
|--------------------------------|--------------------------------|--------------------------|
| 120 Steering knuckle           | 266 Shim                       | 329 Union screw          |
| 125 Sealing ring               | 270 Ball bearing               | 332 Vent pipe            |
| 126 Swivel joint               | 272 Gasket                     | 334 Lock washer          |
| 128 Shim                       | 274 Sealing ring               | 336 Bolt                 |
| 131 Plate                      | 280 Housing                    | 340 Hose                 |
| 132 Grease nipple              | 284 Driven gear                | 342 Clamp                |
| 134 Spring washer              | 286 Cylindrical roller bearing | 346 Clamp                |
| 135 Bolt                       | 288 Shim                       | 350 Steering knuckle arm |
| 140 Spacing ring               | 291 Wear ring                  | 354 Bushing              |
| 141 Sealing ring               | 293 Nut                        | 356 Bolt                 |
| 143 Thrust washer              | 296 Lock washer                | 258 Washer               |
| 146 Swivel joint               | 298 Bolt                       | 362 Steering arm         |
| 148 Thrust washer              | 300 Bolt                       | 365 Washer               |
| 150 Bushing                    | 302 Bolt                       | 367 Bolt                 |
| 151 Sealing ring               | 305 Shaft seal                 | 372 Tie rod              |
| 153 Oil pipe                   | 310 Wheel hub                  | 375 Ball joint           |
| 245 Sealing ring               | 312 Oil deflector              | 377 Cup seal             |
| 248 Shim                       | 315 Wheel stud                 | 379 Nut                  |
| 251 Snap ring                  | 318 Bolt                       | 382 Clamp                |
| 253 Cylindrical roller bearing | 320 Lock washer                | 385 Bolt                 |
| 256 Ball bearing               | 322 Bolt                       | 387 Bolt                 |
| 260 Drive gear                 | 325 Vent pipe                  | 387 Lock washer          |
| 262 Bolt                       | 327 Sealing ring               | 389 Nut                  |